



**ClaroLux**<sup>®</sup>  
LANDSCAPE LIGHTING

## DL20 Specification Sheet DL20 Crescent

### FEATURES

- Lifetime Warranty
- Designed, Finished, Assembled in USA
- Constructed For Extreme Conditions
- Eco-Efficient LED Technology
- Available in Custom Colors & Finishes
- Available Only Through ClaroLux Installation Professionals

### APPLICATIONS

- Illuminating Decks, Steps, Patio Areas, & Docks
- Post, Wall, Solid Surface Mounting
- Ideal For High Traffic & Commercial Locations

### QUICK SPECS

- Bi-Pin
- Max Wattage: 10W
- Wire AWG: 18-2
- Wire Lead: 25ft
- Warranty: Lifetime

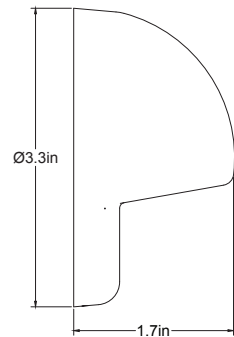

### AVAILABLE FINISHES



Rev 11 | 2.21

**CLAROLUX.COM**  
1039 Westside Drive | Greensboro, NC 27405

Made In The USA • Factory Direct • Professional Grade  
Landscape Lighting Fixtures, Supplies and Accessories